

**HOT WATER BATTERY SPECIFICATIONS**

	DF 403 Through-the-wall single	DF 405 Through-the-wall single	DF 405 Through-the-wall three phase	DF 408 Through-the-wall single	DF 408 Through-the-wall three phase
Power (kW) with primary 50-40 °C / 90-70 °C	4,6/14,6	4,6/14,6	4,6/14,6	5,5/17,6	5,5/17,6
Water flow (m³/h) with primary at 90/70°C	0,65	0,65	0,65	0,78	0,78
Load loss (mCE) with primary 90/70°C	0,055	0,055	0,055	0,078	0,078
Connection (mm)	20 / 27 male thread				

**INSTALLATION**

- Installation in an adjoining technical room.
- Blower and intake grates mounted on the part to be mortared included with the appliance.
- Possibility of double deflector grates to direct the hot, dry air towards the windows.
- Hot water battery assembled inside the appliance (option).
- Extra electric heating using incorporated electric heating elements (option).
- Filter on the intake.
- Standard access panel (electrical connections) on the right in the direction of air flow. If the panel is difficult to access on this side, the electrical unit can be fitted remotely (option exclusively available with the DF unit).

**Installation of an appliance with the hot water battery option.**

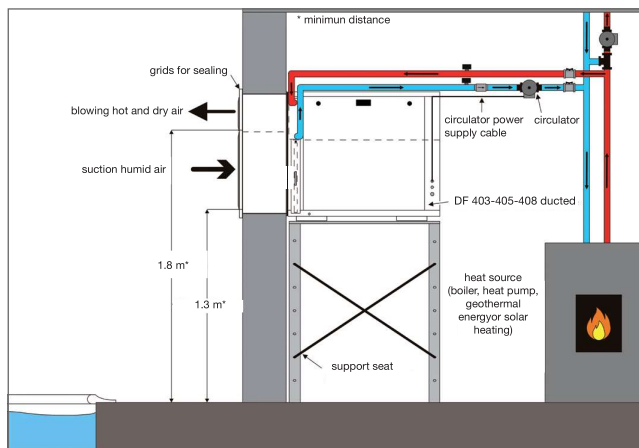

**DIMENSIONS (MM) AND WEIGHT**

	DF 403 Through-the-wall single	DF 405 Through-the-wall single	DF 405 Through-the-wall three phase	DF 408 Through-the-wall single	DF 408 Through-the-wall three phase
Weight (kg) (basic model)	129	130	130	133	133

DF

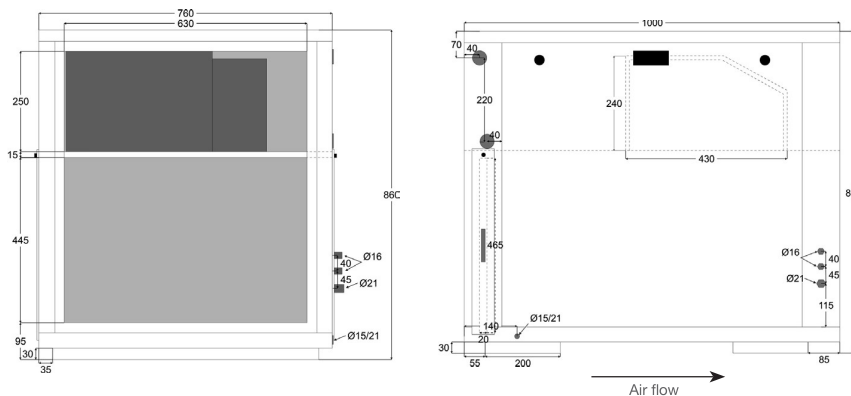

Access panel as standard for electrical connections

Grate to be mortared

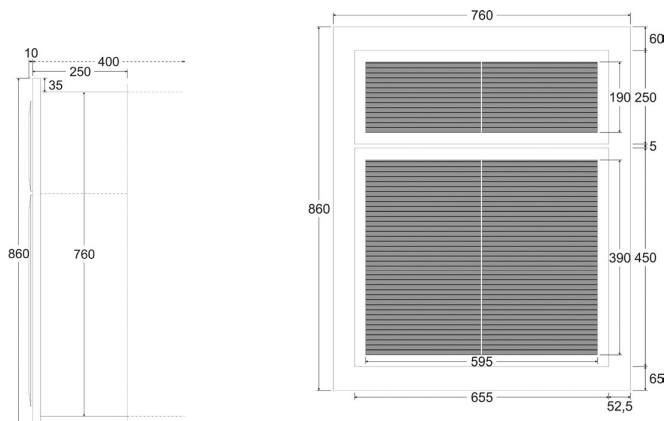

 Spare parts page 276



# DF through-the-wall Through-the-wall system



Dehumidification > DF Through-the-wall

**2** YEAR  
WARRANTY

- + Easy to install in the trough-the-wall, at a height (1.2 to 1.3 m from the ground)
- + Available in 3 capacities (3.5 to 8 l/h)
- + Option: "air heating" (either electric or hot water battery)
- + Modularity: right-hand access panel as standard, with an option for left-hand



	DF 403 Through-the-wall single	DF 405 Through-the-wall single	DF 405 Through-the-wall three phase	DF 408 Through-the-wall single	DF 408 Through-the-wall three phase
<b>PRODUCT REFERENCE</b>					
Standard model	W28DF403ME	W28DF405ME	W28DF405TE	W28DF408ME	W28DF408TE
Model with electric heating option	W28DF403MEE	W28DF405MEE	W28DF405TEE	W28DF408MEE	W28DF408TEE
	4,5 kW	4,5 kW	4,5 kW	4,5 kW	9 kW
Model with hot water battery option	W28DF403MEB	W28DF405MEB	W28DF405TEB	W28DF408MEB	W28DF408TEB
	14 kW	14 kW	14 kW	14 kW	14 kW

<b>ACCESSORIES INCLUDED IN THE PACK</b>			
	Hygro control box		Part to be mortared (DF Through-the-wall grate included)

<b>TECHNICAL SPECIFICATIONS</b>					
Capacity (l/h)	3,5	5	5	8	8
Absorbed power (W)*	1 500	1 860	1 860	2 600	2 600
Operating power (W)*	3 600	4 465	4 465	6 240	6 240
Air flow (m³/h)	1 300	1 300	1 300	1 700	1 700
Electric power supply	230 V / 1 / 50 Hz	230 V / 1 / 50 Hz	400 V / 3N / 50 Hz	230 V / 1 / 50 Hz	400 V / 3N / 50 Hz
Max. absorbed intensity (A)**	13,2	16,1	7,3	24,8	9,5
Refrigerating fluid	R407C				
Refrigerant fluid quantity (g)	1180	1210	1210	1520	1520

For all DF orders a deposit of 30% will be requested with the order.

\* In the following nominal conditions: Air 30°C Humidity 70%.

\*\* Values measured and certified in compliance with standards EN ISO 3741 and EN ISO 354 by the CTM (Centre de Transfert de Technologie du Mans).

### OPTIONAL ACCESSORIES

Double deflector supply grille	Register + double deflector grille	Chassis support DF	Remote control electrical unit
WTT02365	WTT02369	WTO04000	W28DEPORT
<b>59,29€ HT</b>	<b>131,30€ HT</b>	<b>804 € HT</b>	<b>450 € HT</b>